

REIMAGINE THE GRANTON GAS HOLDER

Design sprint outputs

Introduction

On the 14th October 2021 Buro Happold held a design sprint to 'Reimagine the Granton Gas Holder', in collaboration with **Collective Architecture**, **LUC**, and **The City of Edinburgh Council**.

We were delighted to welcome architects, engineers, planners, developers, and other interested parties to get together for some creative blue-sky thinking and hands-on with models and sketches to illustrate their ideas was appreciated by all.

What is a design sprint?

Design sprints have been developed across multiple industries as a way of accessing innovative design thinking and pooling professional design knowledge. It also created an opportunity for visualising those early ideas for the residents and stakeholders to give feedback.

The question explored together was:

'How can the Granton Gas Holder be reimaged to benefit the local and global community?'

Considerations were made for the principles behind the Granton development framework while recognising the importance of local community support for any future initiative and our global commitment to sustainability. Working collaboratively, groups explored how Edinburgh's iconic Granton Gas Holder could become a centrepiece for the Granton Masterplan.

The aim of the sprint

1. Reimagine the gas holder as an iconic symbol of sustainability and a keystone for future generations
2. Encourage feedback and direction for the future of the site

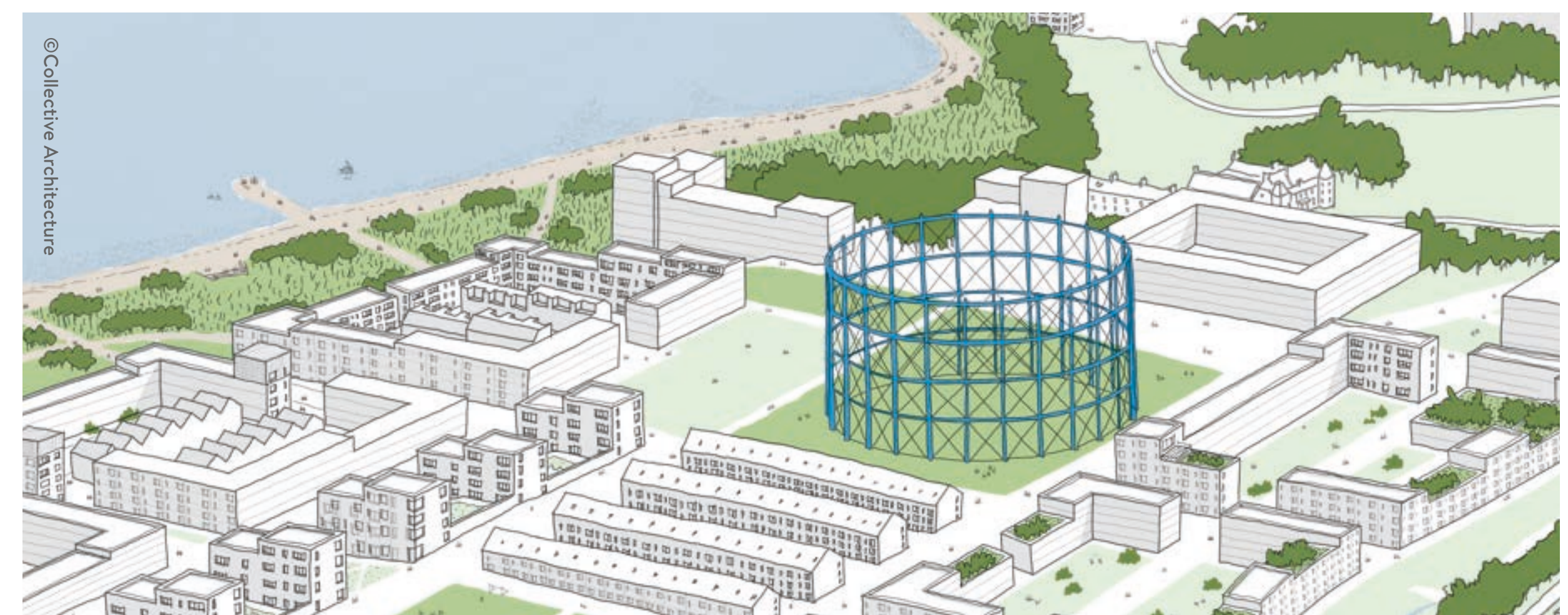

The Principles for the design

<p>COASTAL</p> <p>Celebrating the Firth of Forth's unique shoreline to be inclusive, climate-resilient and biodiverse. Enhancing and expanding spaces to provide open access to natural and urban coastal activities for the neighbourhood, community and city.</p>		<p>URBAN</p> <p>A vibrant urban environment, with space for living in a 21st Century urban condition, providing an intelligent mix of housing, working, education and dynamic civic and cultural destinations.</p>		<p>ROBUST & FLEXIBLE</p> <p>Creating a robust framework, with space for future flexibility to create fresh and diverse opportunities for health, energy, production, work and learning that stand the test of time.</p>		<p>RESPONSIBLE</p> <p>Developing a self-sustaining neighbourhood within the wider city of Edinburgh with a circular economy addressing the climate emergency, work, enterprise, learning, health, energy and social mobility.</p>
	<p>RE-CONNECTED</p> <p>Linking new and existing neighbourhoods not only with each other but with surrounding areas, Granton Harbour and the city - both physically and socially. Ensure regeneration benefits surrounding neighbourhoods and prioritise low carbon travel.</p>		<p>LIVING</p> <p>Inhabiting pleasant streets and open spaces which incorporate nature to improve well-being for all in the community and enhance biodiversity.</p>		<p>ROOTED</p> <p>Reinvigorating existing heritage assets and working in partnership with local community organisations and residents to further strengthen Granton's identity, physical environment and character.</p>	

As created by Collective Architecture

Why not join the discussion and share your sketches or ideas? Or send us feedback and comments on the team ideas. Alternatively feel free to send ideas by post to: Amy Rennie, Buro Happold, 57-59 Bread Street, Edinburgh, EH3 9AH. We will collate all the outputs and pass them onto City of Edinburgh Council.

BURO HAPPOLD

EDINBURGH
THE CITY OF EDINBURGH COUNCIL

COLLECTIVE ARCHITECTURE

Please follow the QR code to the community Miro board.

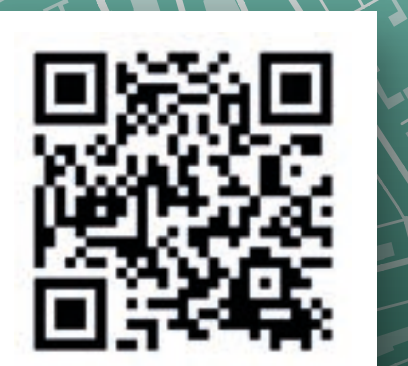

REIMAGINE THE GRANTON GAS HOLDER

Team
2

Design sprint outputs

Reconnected

'Granton 360'

Granton 360
LOCAL ENERGY PRODUCTION & STORAGE
SUSTAINABLE DRAINAGE MICROPOWER, GREEN ENERGY
EVENTS SPACE/AUDITORIUM
ACTIVITY HUB
CLIMBING AREA
VIEWING GALLERY
HANGING GARDENS

GREEN ENERGY TO THE COMMUNITY

SUSTAINABLE ROOF AND LANDSCAPE DRAINAGE

SUSTAINABLE DRAINAGE NETWORKS FEEDING MICROPOWER...

Hydroponic OUTFALL

development of allotments for local food production

theatre in the tank space

working to create a circular economy..

How can we reuse its original purpose but in an alternative green way?

Hydro scheme - water storage and hydro rain gardens

reusing the "balloons" for accommodation of education centres?

Graviticity - can we use height for energy storage?

use gas cylinders for composting/farm production/education centre/data centre

recycling programme / hub

green energy centre

viewing place

trees growing inside - scots pine

hydro rain gardens

water storage or energy storage

auditorium

event space

EUROPE
Connecting Existing Communities with new

Algae Farm

Hydro Scheme

Green Energy

Community Letts

Data Centres

Group 2 Reconnected

Match Project Schwere - Rafter - Strabe

Leisure based Destination

Functional - Become Urban's attraction

Climbing frame

Stairs / bike paths

Tourist Attraction/Community Usage

To Cover Maintenance Costs.

Venue/ Concert Hall.

Weight varied during time around

slowly

weight dropped to generate electricity

GRAVITICITY system

Local energy production + storage.
Green energy within same or old energy.
Community Power + Environment sustainable future.
Place for:
- Cinema
- Pub
- Lounge
- Performance
- Viewing
- Reception
A visible symbol of Net Zero Edinburgh + A community resource.

Team 2

Jordan McCrae Collective Architecture
Ewan Anderson 7N
Greg Meikle LDA
Frazer McNaughton Nature Scotland
Anne Grove Scottish Government
Amy Rennie Buro Happold Lighting
Olivia Bennett Buro Happold PDM
Thomas Eckhart Buro Happold Cities Bridges
James Hobson Buro Happold Waste



BURO HAPPOLD

EDINBURGH
THE CITY OF EDINBURGH COUNCIL

COLLECTIVE ARCHITECTURE

Please follow the QR code to the community Miro board.

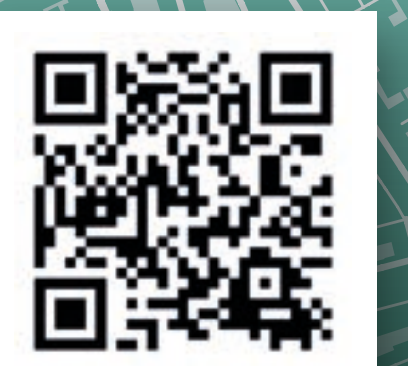

REIMAGINE THE GRANTON GAS HOLDER

Team
3

Design sprint outputs

Urban

'Since 1900'

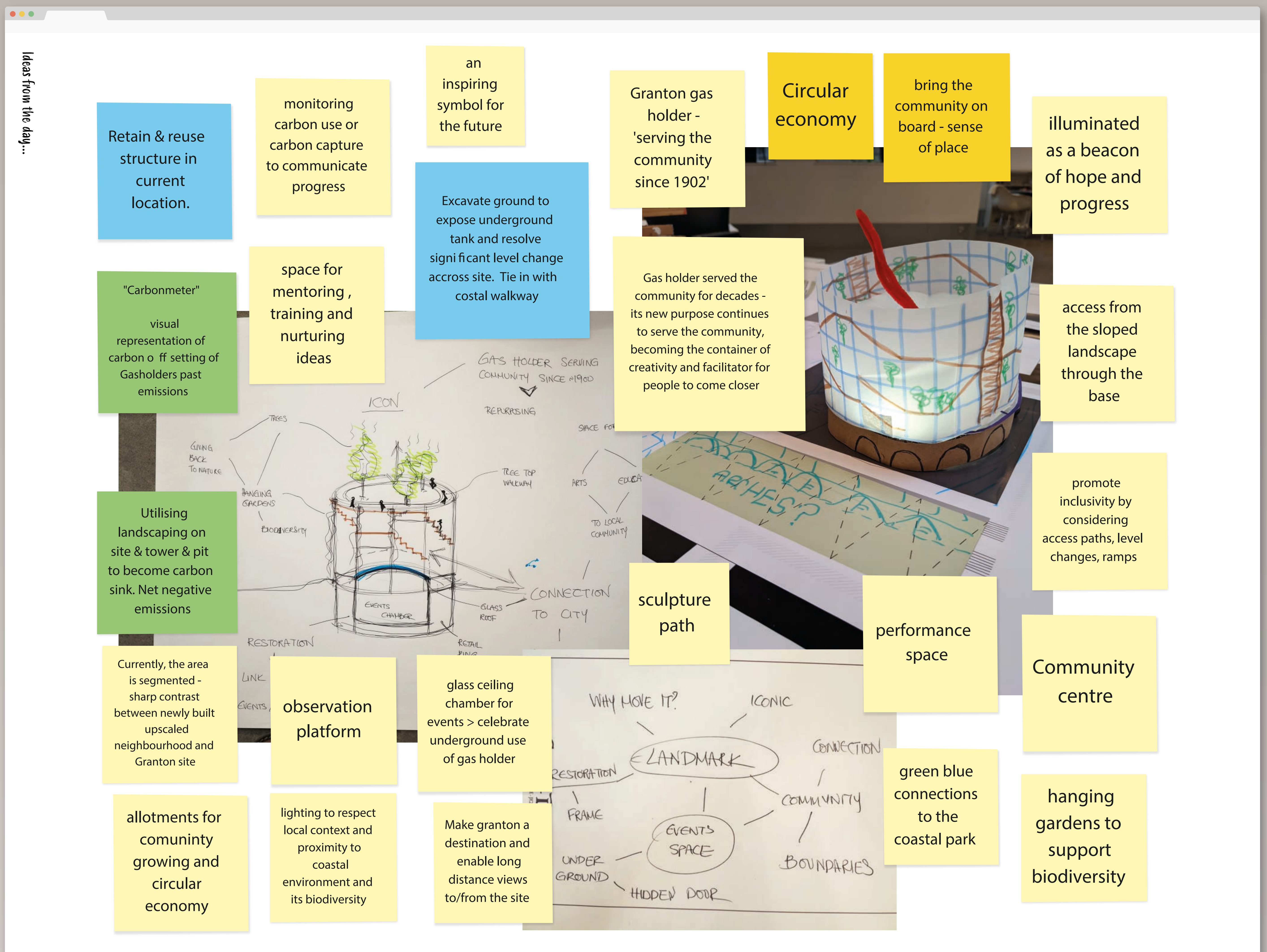

Team 3

- Satyam Patel
- John Lawson
- Lucy Tate
- Ian Thompson
- Jakki Jeffery
- Alexia Gkika
- Sam Haston
- Flora Fraser
- CEC
- CEC
- LUC
- HES
- Edinburgh college
- Buro Happold Lighting
- Buro Happold MEP
- Buro Happold Heritage Structures



BURO HAPPOLD

EDINBURGH
THE CITY OF EDINBURGH COUNCIL

COLLECTIVE ARCHITECTURE

Please follow the QR code to the community Miro board.

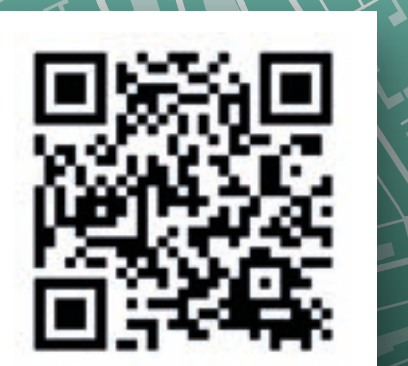

REIMAGINE THE GRANTON GAS HOLDER

Team
4

Design sprint outputs

Living

'CH4 EH5'

Ideas from the day...

**CH4
EH5**

Incorporate a lookout within the design.

climate university?

a life support centre



a climate exchange centre

viewing platform

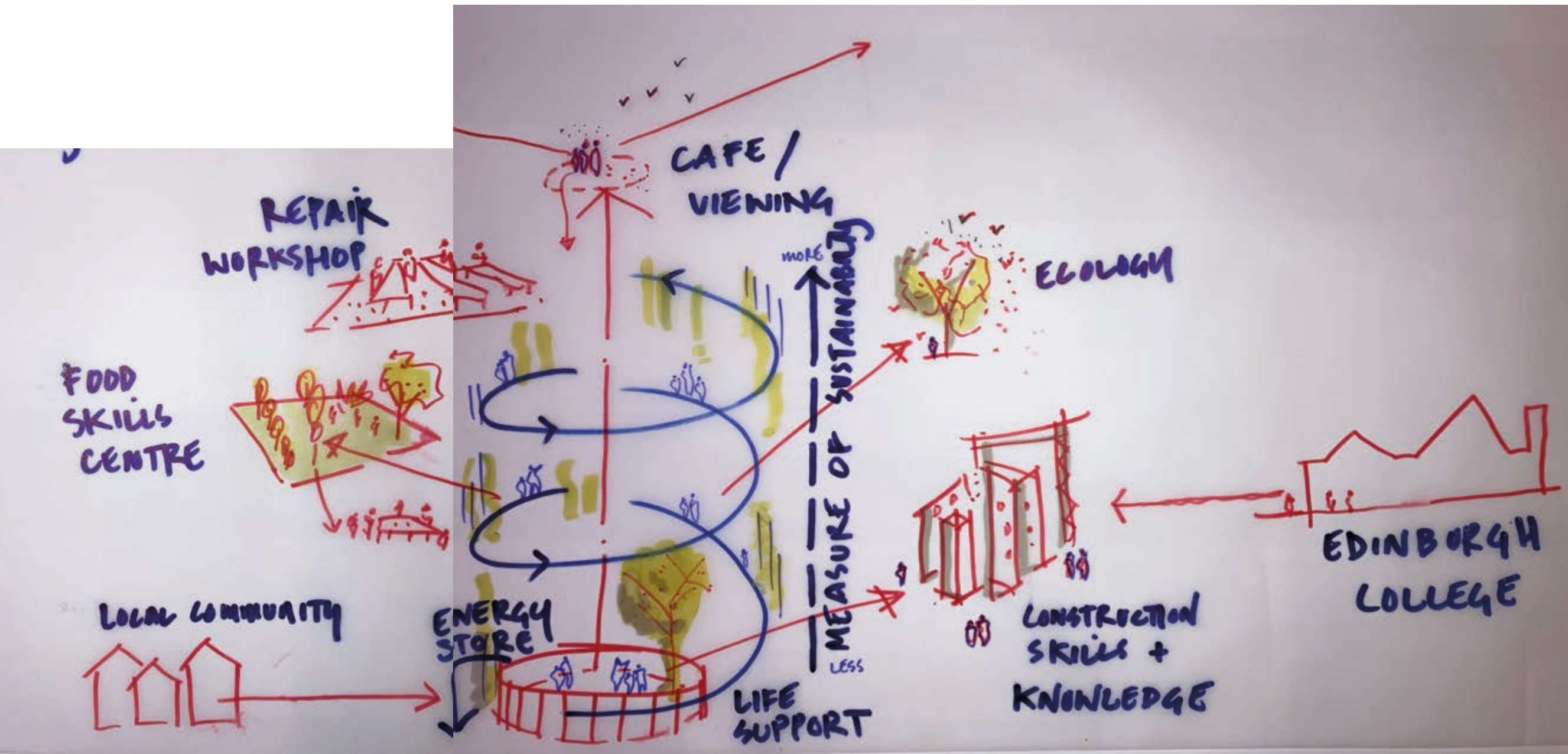
Could the gas holder be used as a large interseasonal energy store?

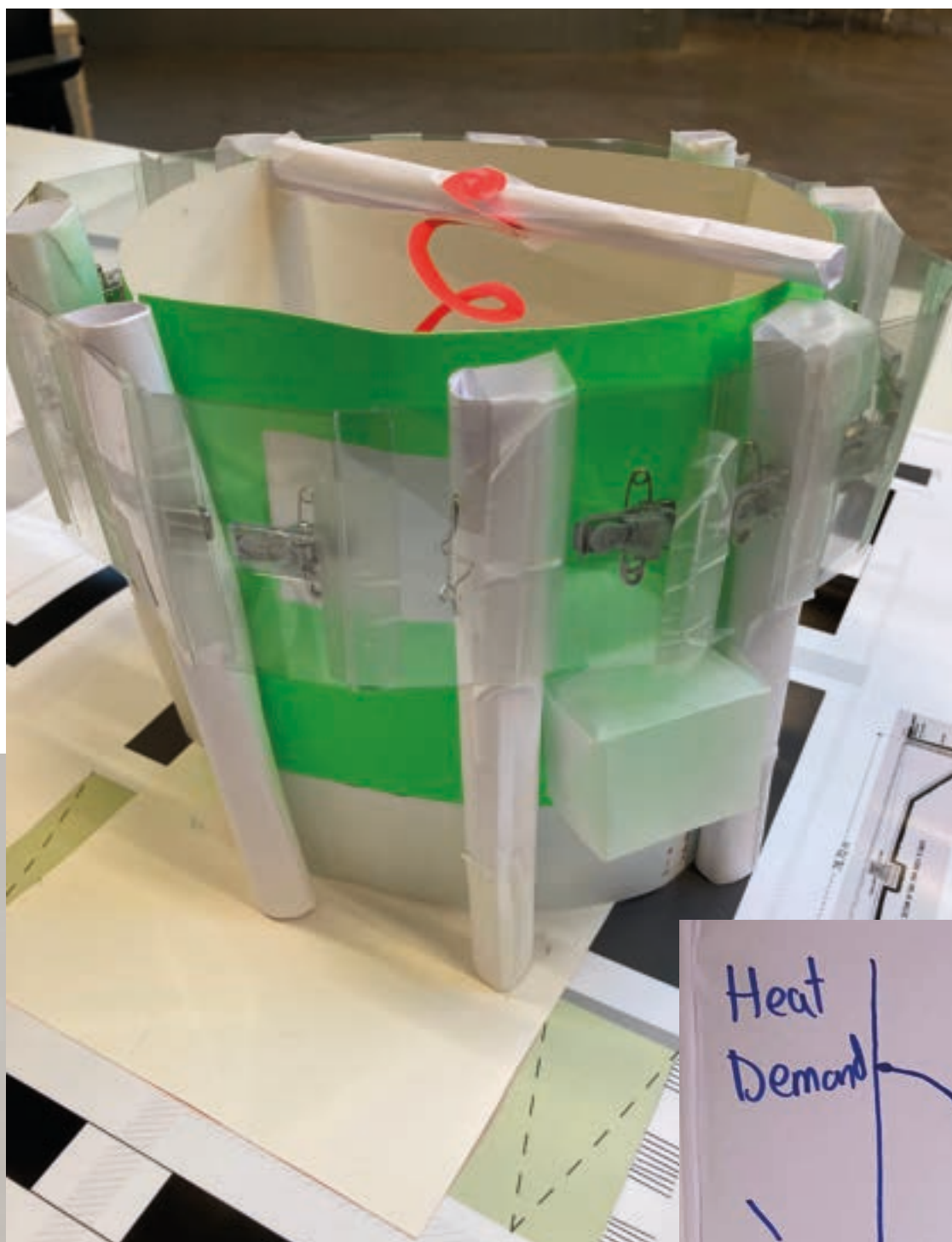
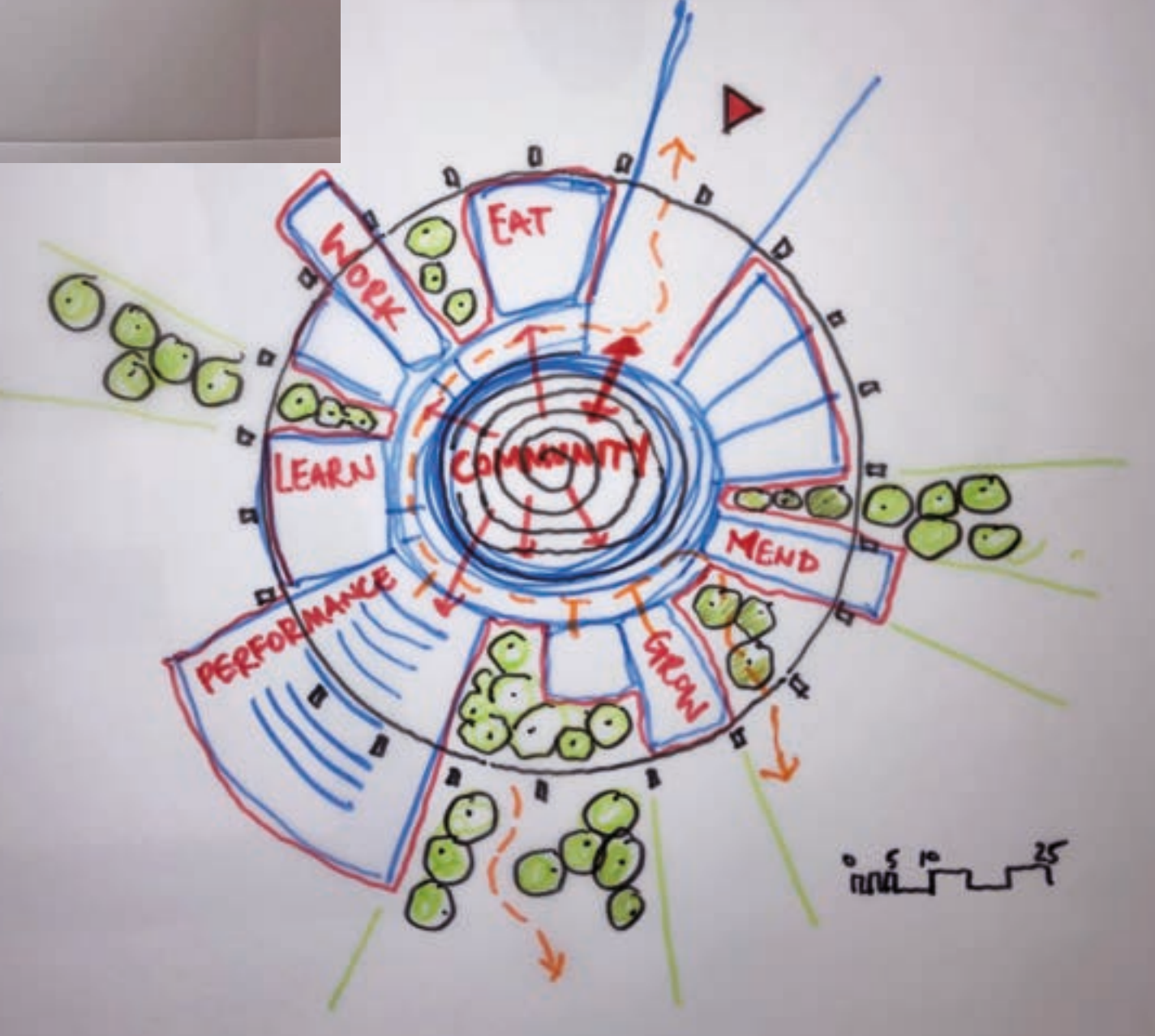

Create a transparent space within the gas holder which could be used as a community garden, horticultural research, offices, cafes etc. intersected by a spiralling staircase in the centre.

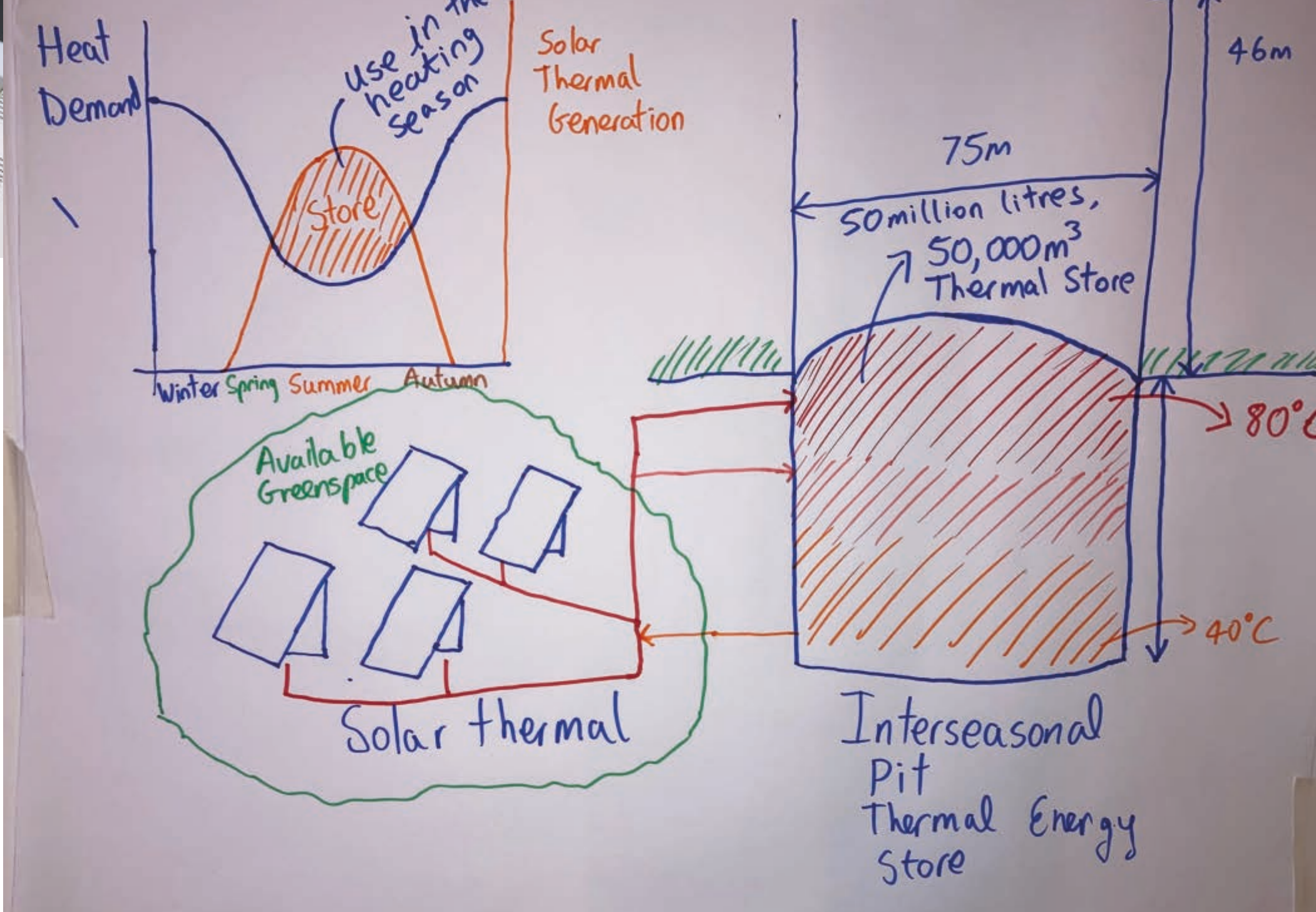
Team 4

David Cowen
Fay Butler
Natalie Taylor/Jack Ridge
Paul East
Dave Keen
Kate Carter
Keith Mackie
Myrto Sktreta Krikou
Anna Wendt
Cian O'flynn

Scottish Government
CEC
National Galleries
John MacAslan Partners
Edinburgh College
University of Edinburgh
Chris Stewart Group
Buro Happold Lighting
Buro Happold Facades
Buro Happold Energy



BURO HAPPOLD

EDINBURGH
THE CITY OF EDINBURGH COUNCIL

**COLLECTIVE
ARCHITECTURE**

Please follow the QR code to the community Miro board.

